

別図1

[illegible][illegible][illegible]

[illegible][illegible][illegible][illegible]

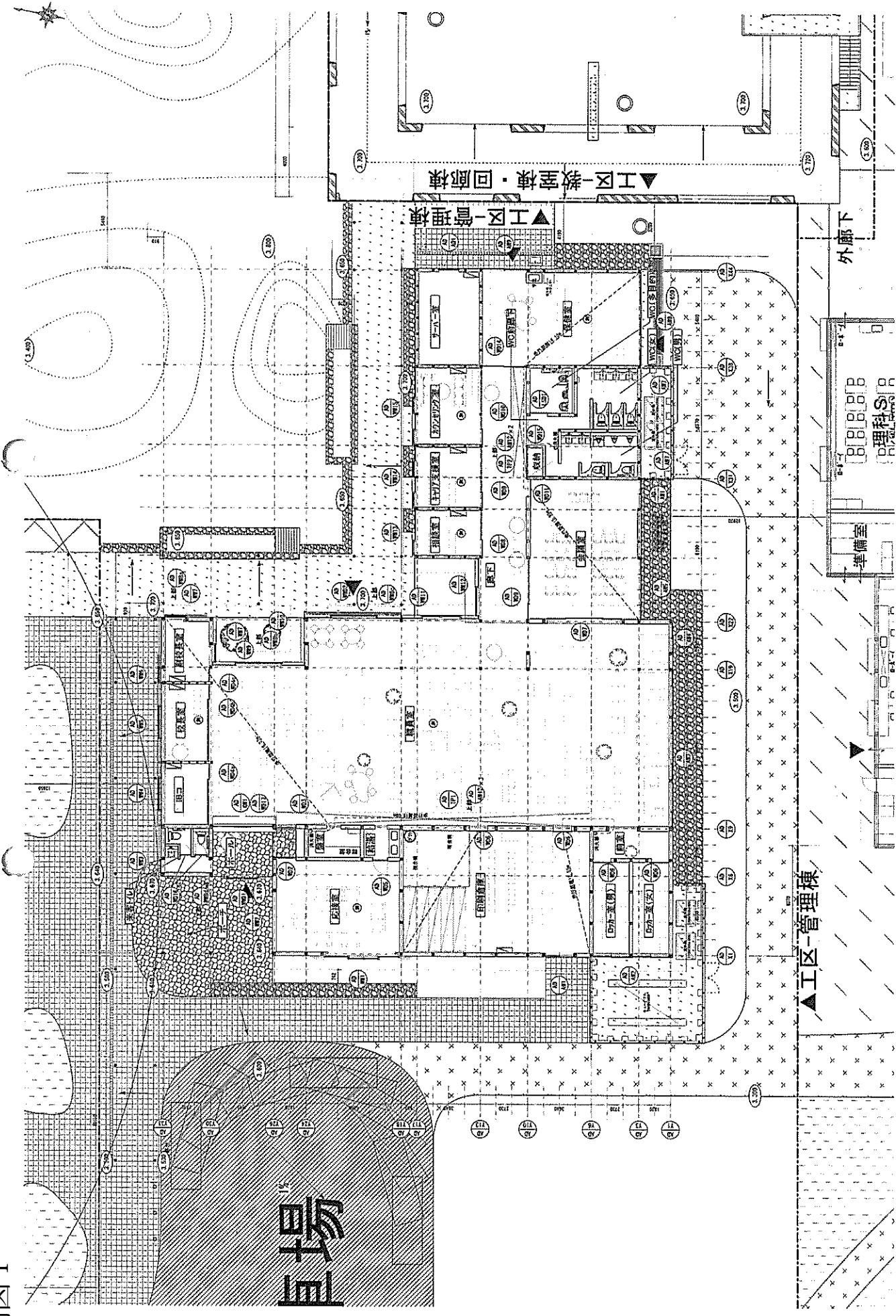
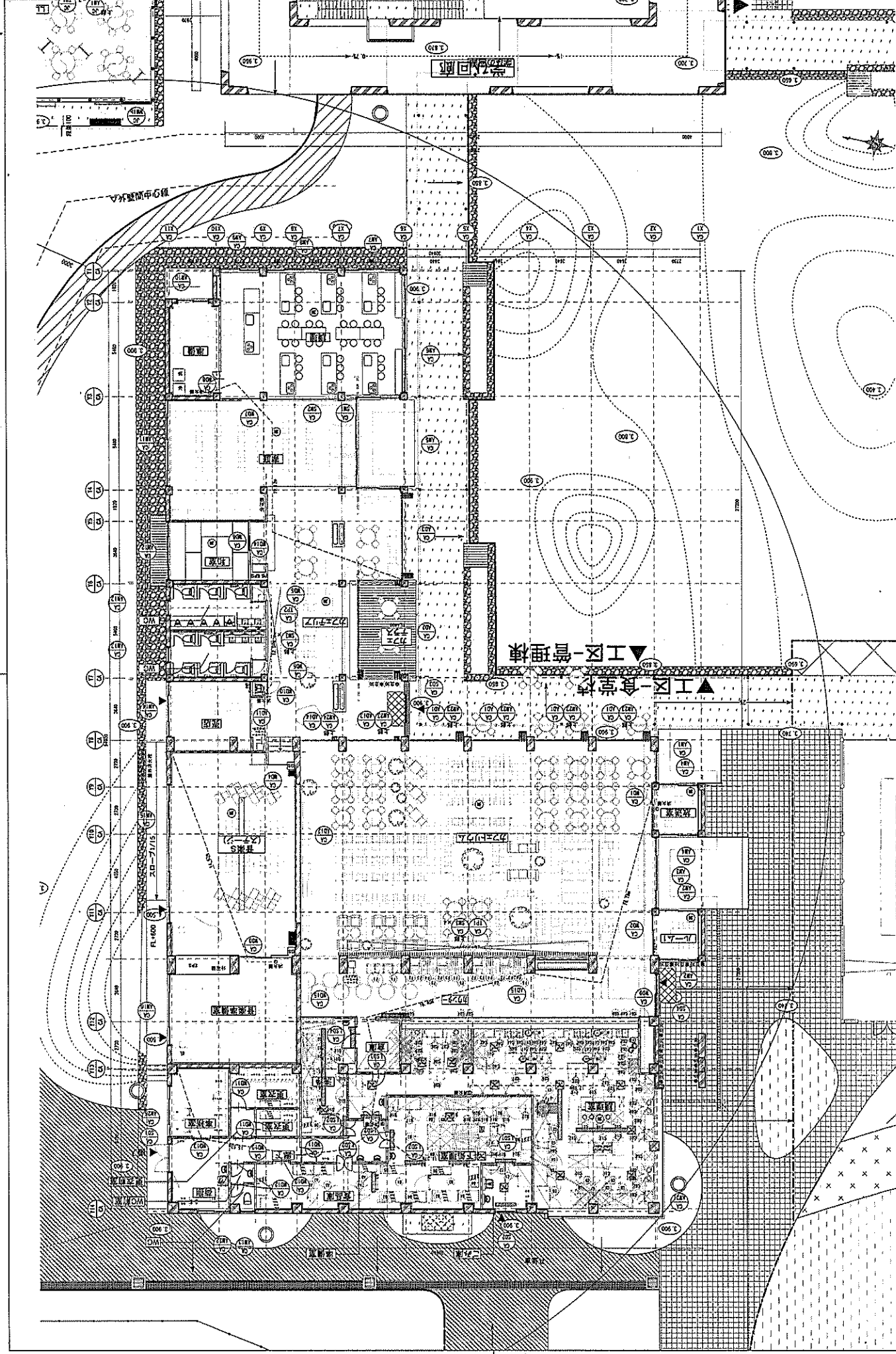
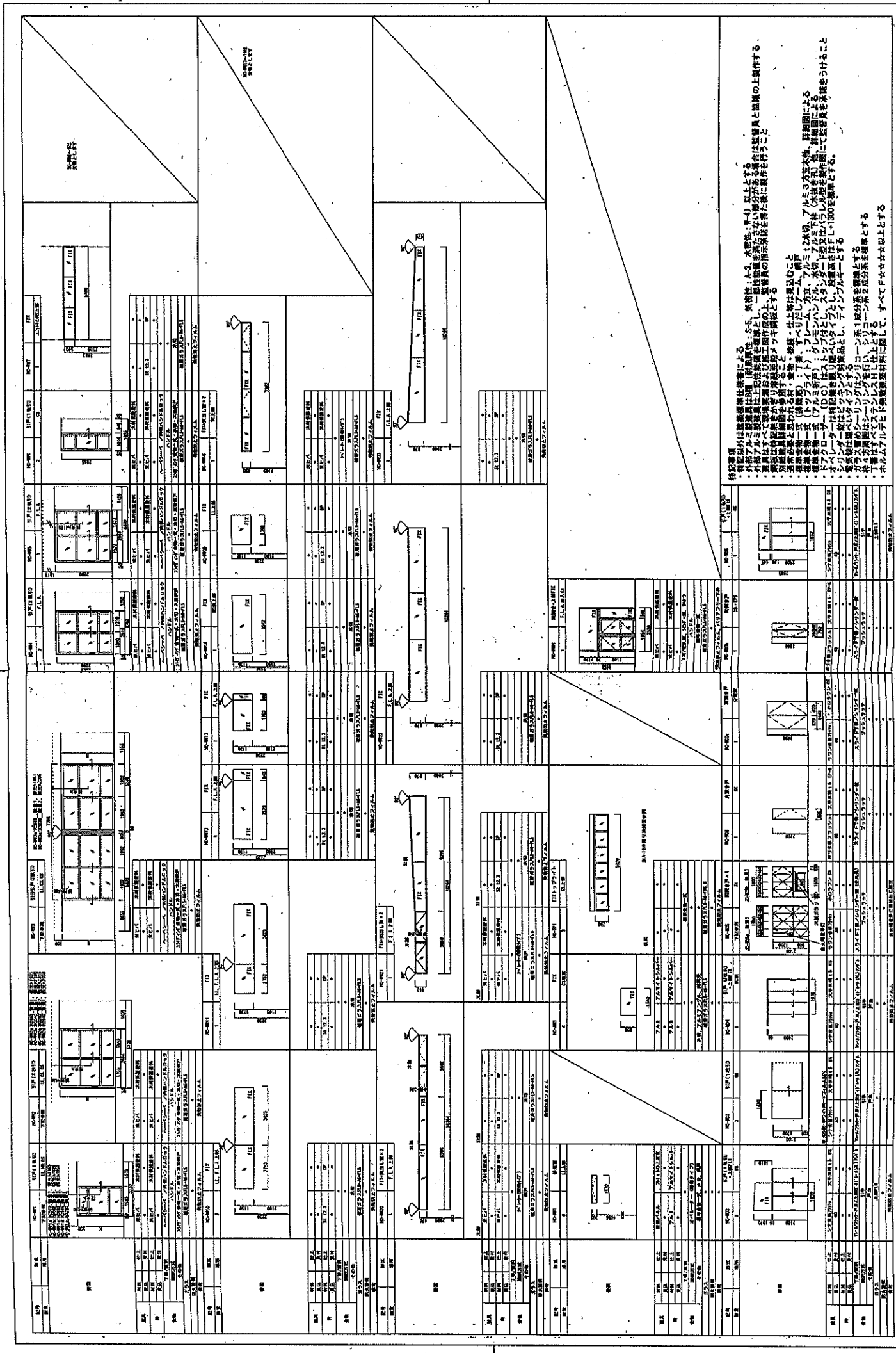
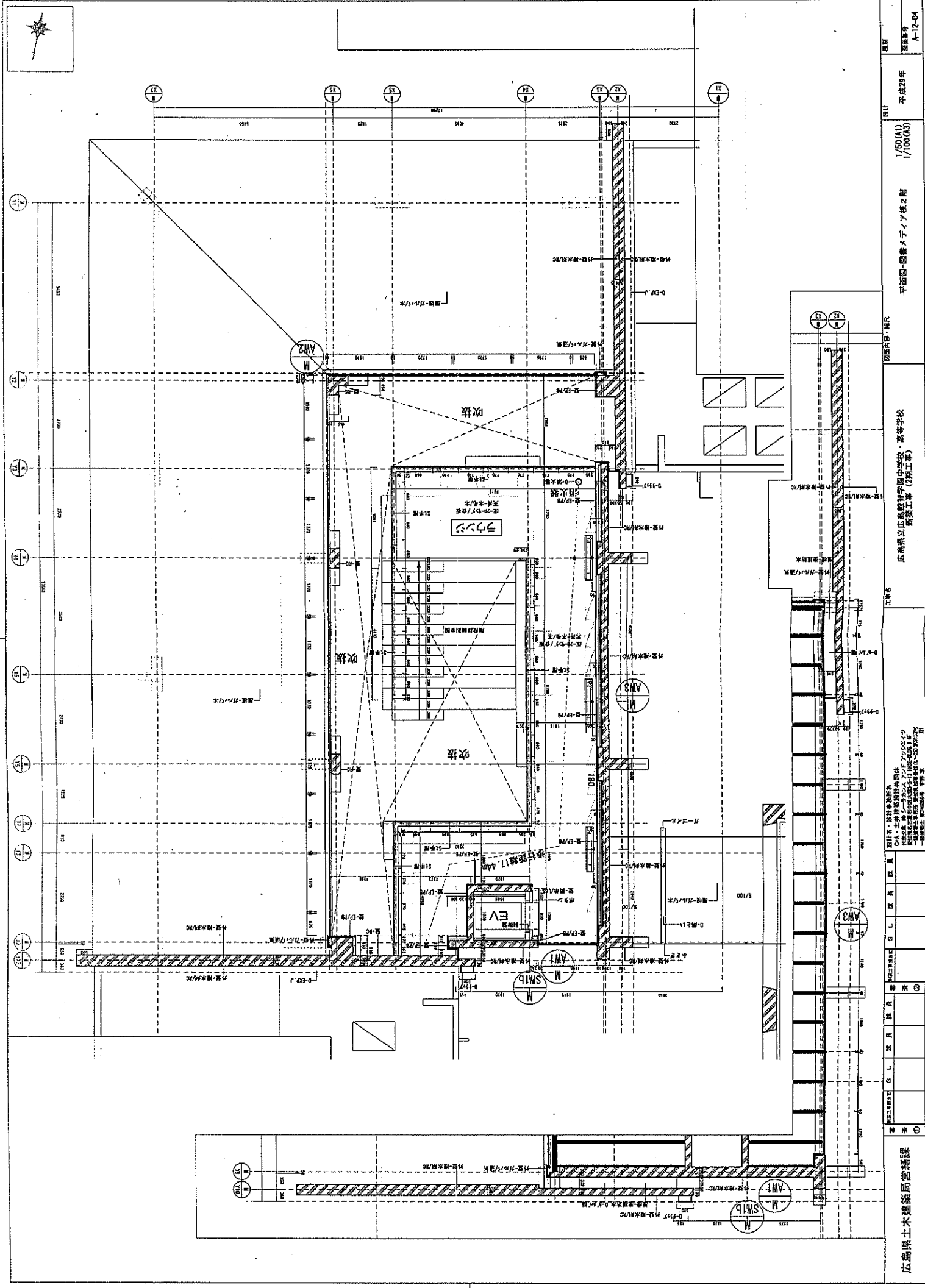

Architectural drawings including floor plans, elevations, and a detailed table of materials and specifications. The table lists items such as '外装アルミ樹脂複合板' (Exterior Aluminum Resin Composite Board) and '内装アルミ樹脂複合板' (Interior Aluminum Resin Composite Board) with their respective specifications and quantities.

Technical specifications and notes for the building project. The text describes the materials and construction details, including the use of aluminum resin composite boards and the specific requirements for the building's exterior and interior finishes.

Architectural drawings of the building's exterior and interior. The drawings include a detailed floor plan of the first floor, showing the layout of the building and the placement of various rooms and fixtures. The exterior drawing shows the building's facade and the placement of windows and doors. The drawings are labeled with various codes and numbers, indicating the specific details and materials used in the construction.

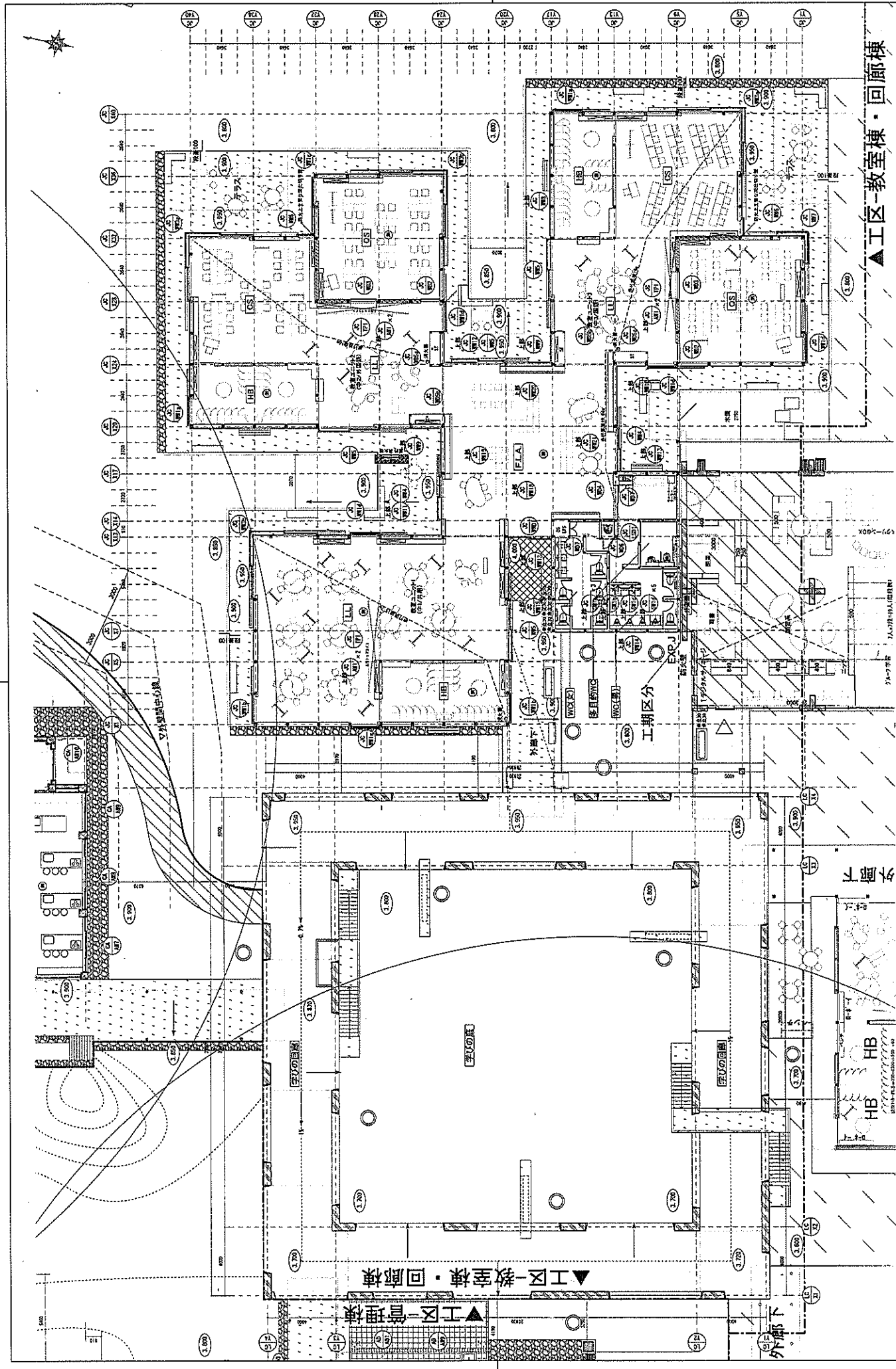
[illegible][illegible]